



Microsoft®

ENGLISH - EN

PORTUGUÊS (BRASIL) - XC

ESPAÑOL (LATINOAMÉRICA) - XX

FRANÇAIS (CANADA) - XD

www.microsoft.com/hardware

①

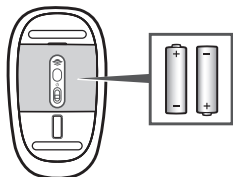

www.microsoft.com/hardware/productguide

②

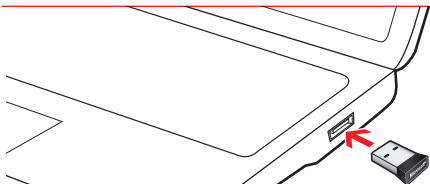

③



www.microsoft.com/hardware/downloads

i1

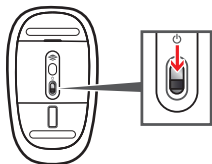

i2



www.microsoft.com/hardware/support

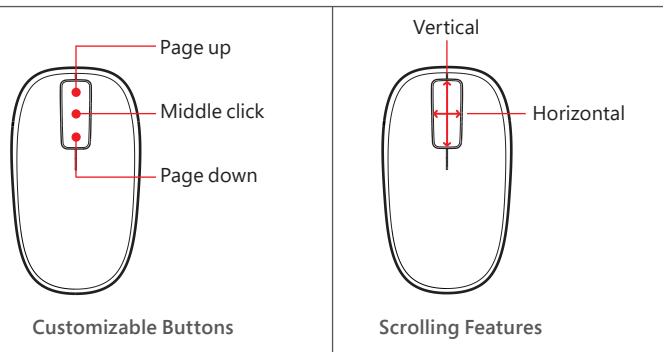

- ① Insert two AA alkaline batteries.
- ② Insert the transceiver into a USB port on your computer.
- ③ Download and install the software to configure touch scrolling.

Information

- i1 When not in use: turn off the power switch to save the battery.
- i2 When not in use: you can leave the transceiver in your computer or store it in the bottom of the mouse.

1

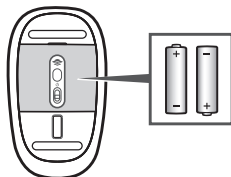

www.microsoft.com/hardware/productguide

2

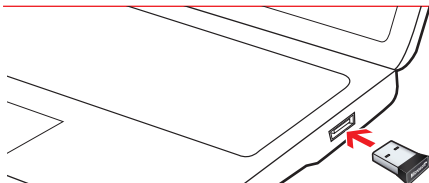

3



www.microsoft.com/hardware/downloads

i1

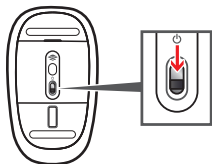

i2



www.microsoft.com/hardware/support

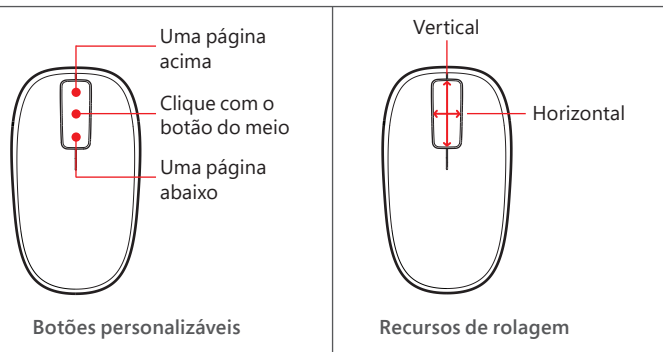

- 1 Insira duas pilhas alcalinas do tipo AA.
- 2 Insira o transceptor em uma porta USB do computador.
- 3 Baixe e instale o software para configurar a rolagem por toque.

Informações

- i1 Quando não estiver em uso: desligue o dispositivo para economizar a energia das pilhas.
- i2 Quando não estiver em uso: mantenha o transceptor em seu computador ou armazene-o na parte inferior do mouse.

①

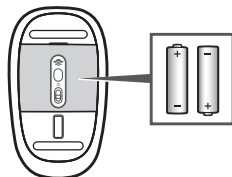

 www.microsoft.com/hardware/productguide

②

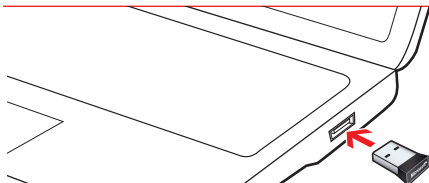

③



www.microsoft.com/hardware/downloads

i1

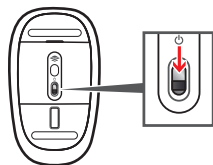

i2



www.microsoft.com/hardware/support

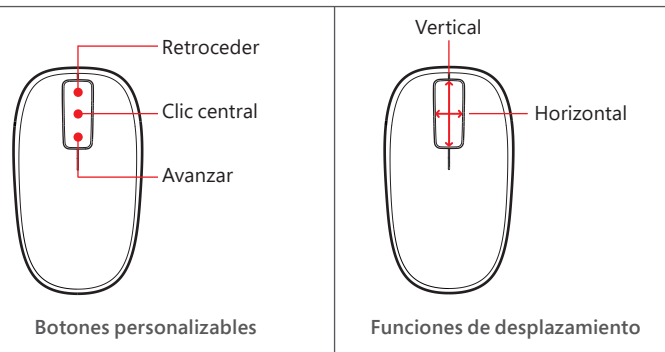

- ① Inserte dos pilas alcalinas AA.
- ② Inserte el transceptor en el puerto USB del equipo.
- ③ Descargue e instale el software para configurar el desplazamiento táctil.

Información

- i1 Cuando no lo utilice: apague el interruptor para ahorrar pilas.
- i2 Cuando no lo utilice: puede dejar el transceptor en el equipo o guardarlo en la parte inferior del mouse.

①

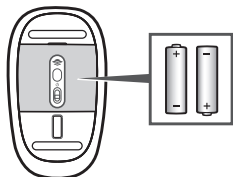

www.microsoft.com/hardware/productguide

②

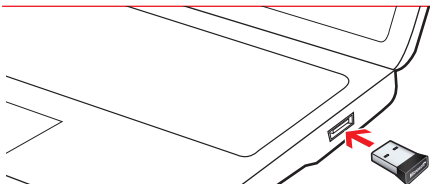

③



→ www.microsoft.com/hardware/downloads

i1

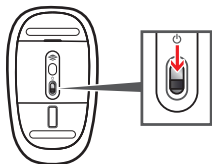

i2



www.microsoft.com/hardware/support

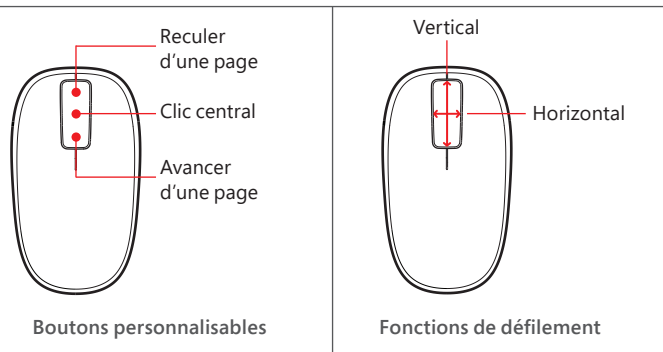

- ① Mettre deux piles alcalines AA.
- ② Branchez l'émetteur-récepteur sur un port USB de votre ordinateur.
- ③ Téléchargez et installez le logiciel pour configurer le défilement au toucher.

Information

- i1 Lorsque vous ne l'utilisez pas : mettez la souris hors tension pour économiser la durée de vie de la pile.
- i2 Lorsque vous ne l'utilisez pas : vous pouvez laisser l'émetteur-récepteur dans le port USB de votre ordinateur ou le ranger dans la base de la souris.



X18-28614-01
