

Microsoft Dynamics AX 2012 R3 Licensing Quick Reference Guide

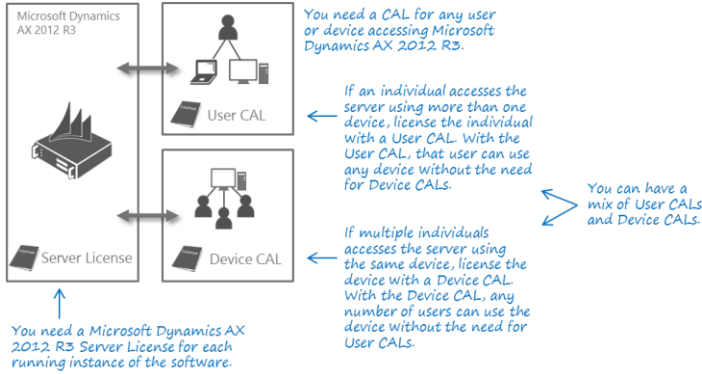

Summary

Microsoft Dynamics AX 2012 R3 is available under the Server/CAL licensing model. Under this model, a Server license is required for the server(s) running the solution, and Client Access Licenses (CALs) are required for accessing the servers.



Access by External Users

Your or your affiliates employees, contractors or agents require a CAL to access your Microsoft Dynamics AX 2012 solution. Your customers do not require a CAL to access your Microsoft Dynamics AX 2012 solution to manage their accounts and orders. However, your customers may not use your software to manage any portions of their business. Notwithstanding the foregoing, CALs are required for access through Microsoft Dynamics AX 2012 clients.

Multiplexing

Multiplexing is the use of hardware or software to reduce the number of devices or individuals that access or use the Microsoft Dynamics AX 2012 R3 solution by pooling connections. Multiplexing does not reduce the number of licenses required to access Microsoft Dynamics AX 2012 R3 solution. Any user that accesses the Microsoft Dynamics AX 2012 R3—whether directly or indirectly—must be properly licensed.

Note: Licensed users may manually rekey information (when coming from non-licensed users) into the Microsoft Dynamics AX 2012 R3 solution. This scenario is not considered to be multiplexing.

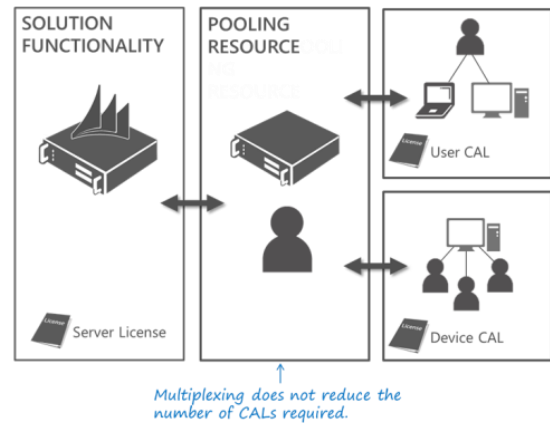

Licensing a Server to Run the Microsoft Dynamics AX 2012 R3 Solution

Before you run any instance of the Microsoft Dynamics AX 2012 R3 Server software under a Server license, you must assign that license to one of your servers. That server is the licensed server for that particular license. You may assign other Server licenses to the same server, but you may not assign the same license to more than one server. A hardware partition or blade is considered to be a separate server. For each Microsoft Dynamics AX 2012 R3 Server license you assign, you may run, at any one time, one instance of the server software in one physical or virtual operating system environment (OSE) on the licensed server. The Server license includes one application object server. If you want additional application object servers or additional server instances, you must purchase additional Microsoft Dynamics AX 2012 R3 Server licenses.

Licensing Access to the Microsoft Dynamics AX 2012 R3 Solution

Access to the Microsoft Dynamics AX 2012 R3 solution's functionality is licensed through CALs. Any time a user directly or indirectly accesses the solution functionality, that user must be licensed by a User CAL (which licenses a specific user for access via multiple devices) or the device being used must be licensed by a Device CAL (which licenses access through a specific device by any user).

There are four available CAL levels for Microsoft Dynamics AX 2012 R3, each of which grants an increasingly wider spectrum of use rights. This gives customers the flexibility to license the solution based on how their users will use and derive value from the solution.

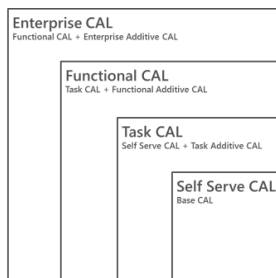

As you progress from the lowest level CAL (Self Serve) to the highest level (Enterprise), the user is licensed to use the solution in ways that will provide more value. Customers therefore have the flexibility to decide the level of investment to make based upon the functions a certain group of users is performing on behalf of the organization.

Licensing Additional Software

Licenses for additional software that may be required for the solution, such as Windows Server, Microsoft SQL Server, and Microsoft SharePoint Server and their corresponding CALs are not included with the Microsoft Dynamics AX 2012 R3 licenses. They must be acquired separately in accordance with licensing models for those products. These licenses may be purchased through traditional volume licensing channels.

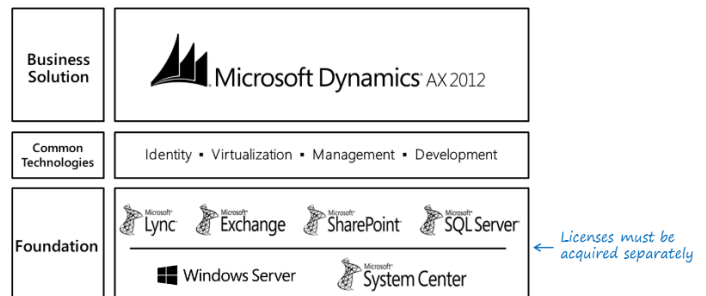

The information contained in this document represents the current view of Microsoft Corporation on the issues discussed as of the date of publication. Because Microsoft must respond to changing market conditions, this document should not be interpreted to be a commitment on the part of Microsoft, and Microsoft cannot guarantee the accuracy of any information presented after the date of publication. This document is for informational purposes only. MICROSOFT MAKES NO WARRANTIES, EXPRESS, IMPLIED, OR STATUTORY, AS TO THE INFORMATION IN THIS DOCUMENT.

©2014 Microsoft Corporation. All rights reserved.