

Surface Hub SSD Replacement Guide

April 2016

Solid State Drive Replacement (55" and 84" Surface Hub)

 **WARNING:** Make sure the Surface Hub is turned off at the AC switch.

1. Locate the SSD compartment door on the rear, upper portion of the Surface Hub in the locations illustrated below. The door is identifiable as it doesn't have open ventilation slots.

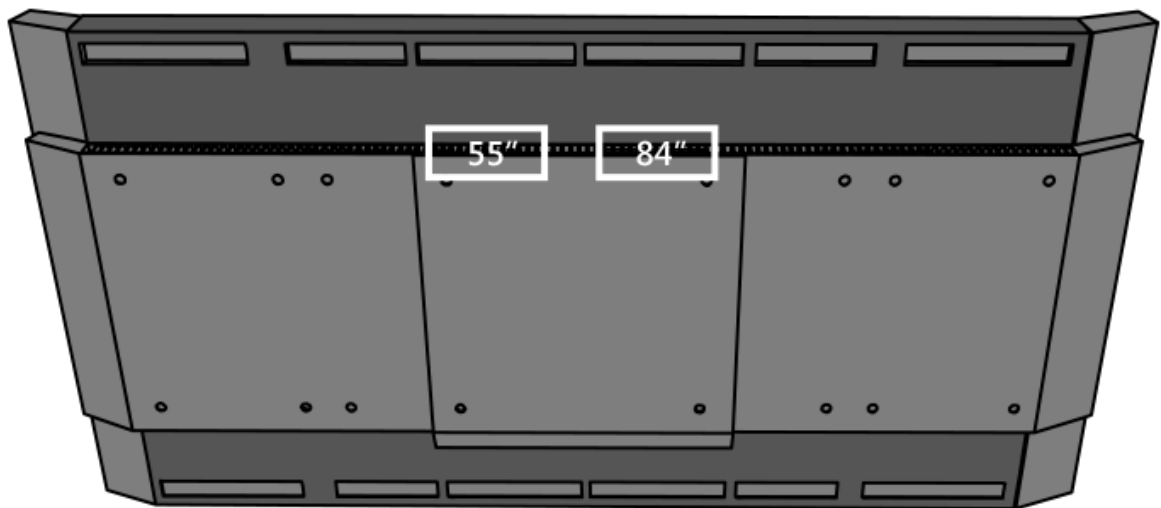

Surface Hub hard drive locations

2. Locate the locking tab on the hard drive compartment door. On the Surface Hub 55, the locking tab will be located on the left-hand side of the door. On the Surface Hub 84, it will be on the right-hand side as shown in the illustration.

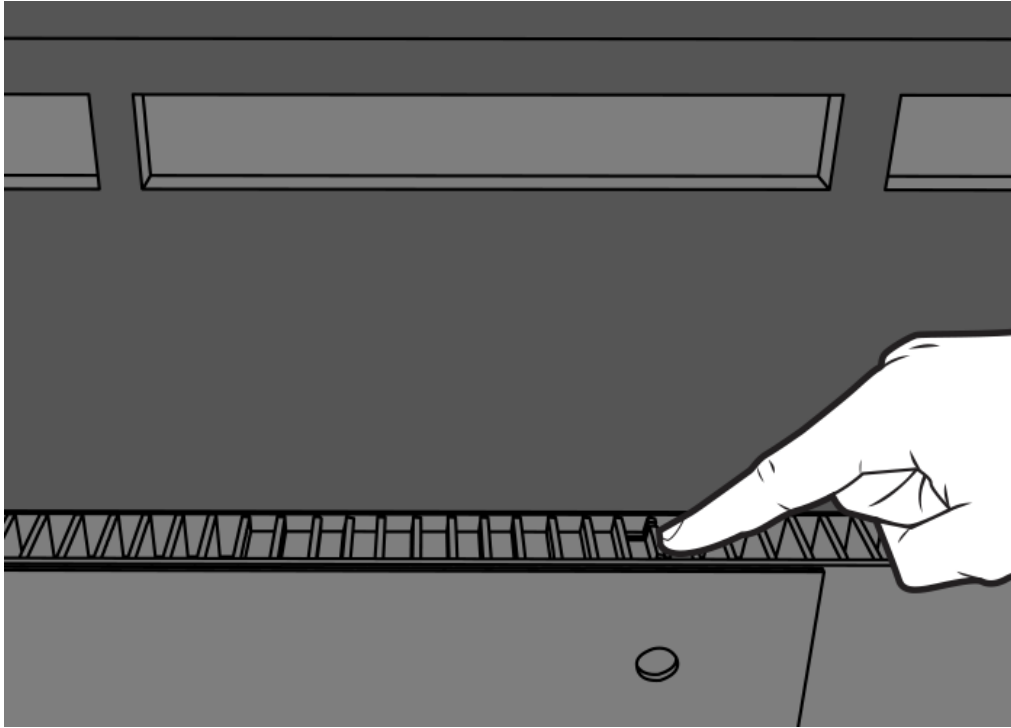

3. Lift open the compartment door to access the hard drive.

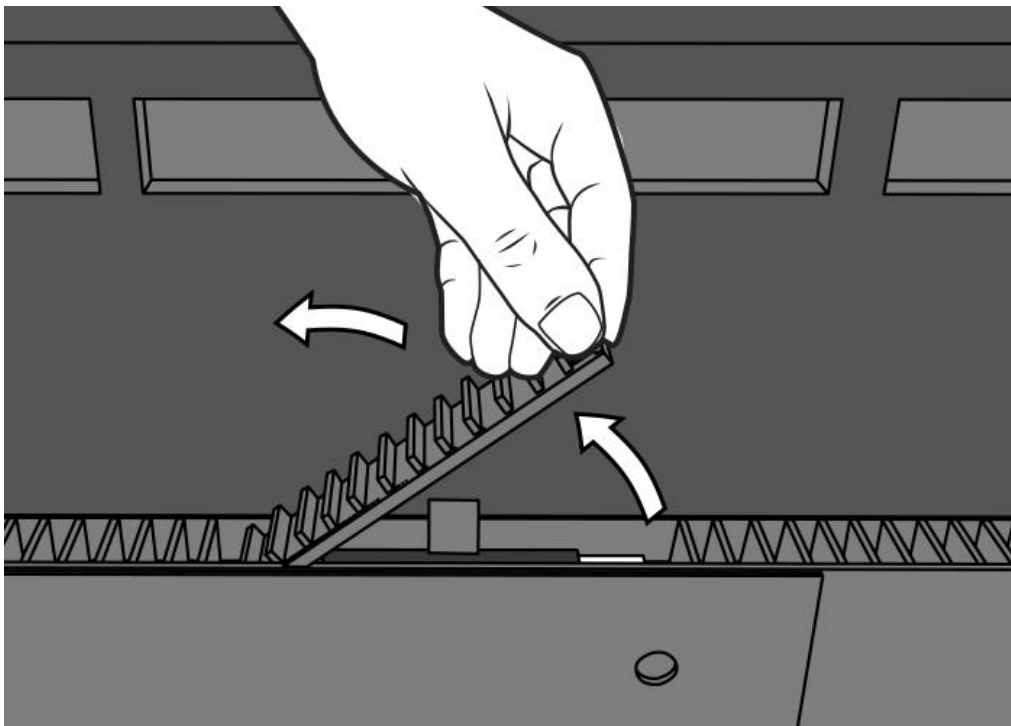

4. Locate the pull tab, which may be partially hidden under the rear cover. Pull on the tab to eject the hard drive from the compartment.

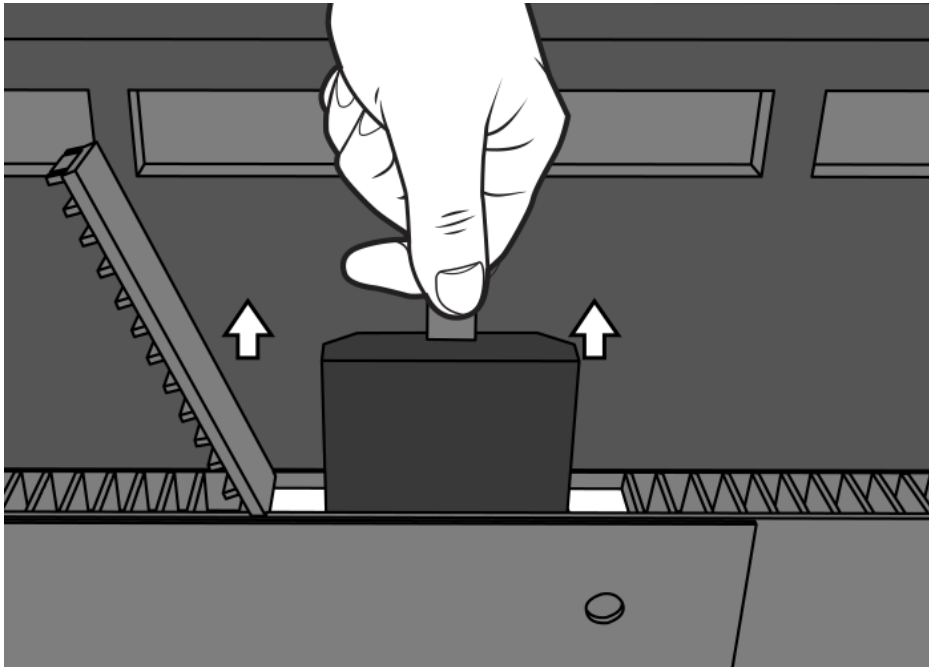

5. Slide the replacement drive into place until you hear it click.

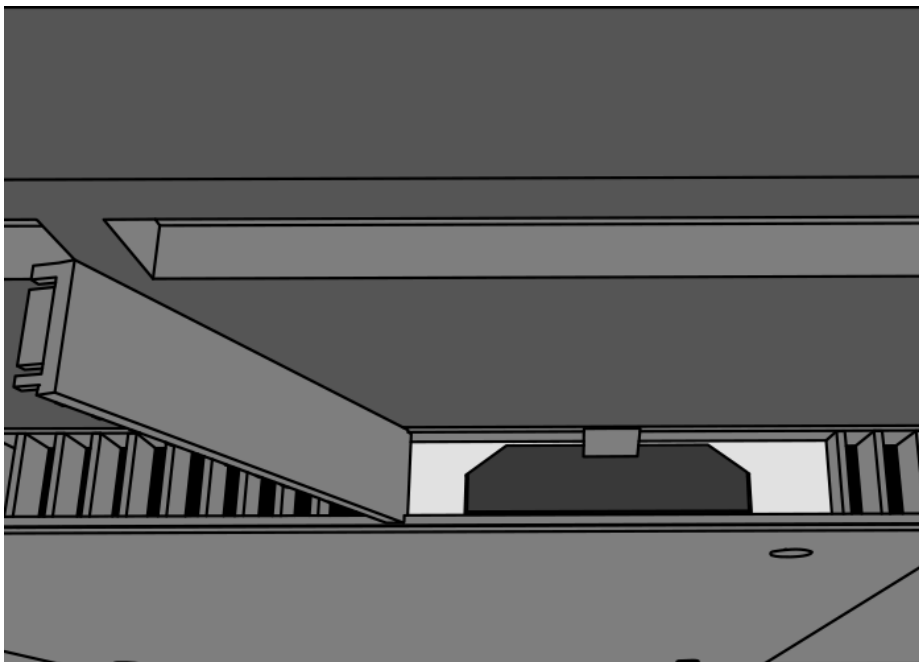

6. Close the compartment door.
7. Apply power to the Surface Hub and proceed.